



Disability Homes Investments

Strong Yields with the Power to Change Lives



125 York St, Nundah. 4012

High Yield SDA Home

4 Two Bed SDA Units plus carer apartment

App: \$2,400,000 House & Land 607m²

Possible Net Income: \$391,336pa.

Projected 16.31% Net Yield

Note: Incomes & projected yields are subject to occupancy & type of participants housed

DESCRIPTION

Platinum Plus, SDA registered 4 x 2 Bed Units on
1 Title Building and Land Package!

All Platinum Plus Houses come standard with;
On-site Overnight Accommodation in a self
contained unit for 24hr support; premium
ceiling rails; extra large bedrooms with
kitchenette and ensuite, solar and battery
backup power supply; fully automated doors,
windows, blinds, air-conditioning, entertainment
systems and communication.

BEDROOMS 8 PLUS CARER

LAND 607M2

BUILT 580 M2

PRICE APP: \$2,400,000

Design elements required to meet accessibility
standards have been re-imagined so that their
intended purpose can be mistaken for an
aesthetic rather than functional design choice.

Public Transport: Buses, walk to shops
restaurants , cafes. Hospital just mins away by
car.

PLANS

01

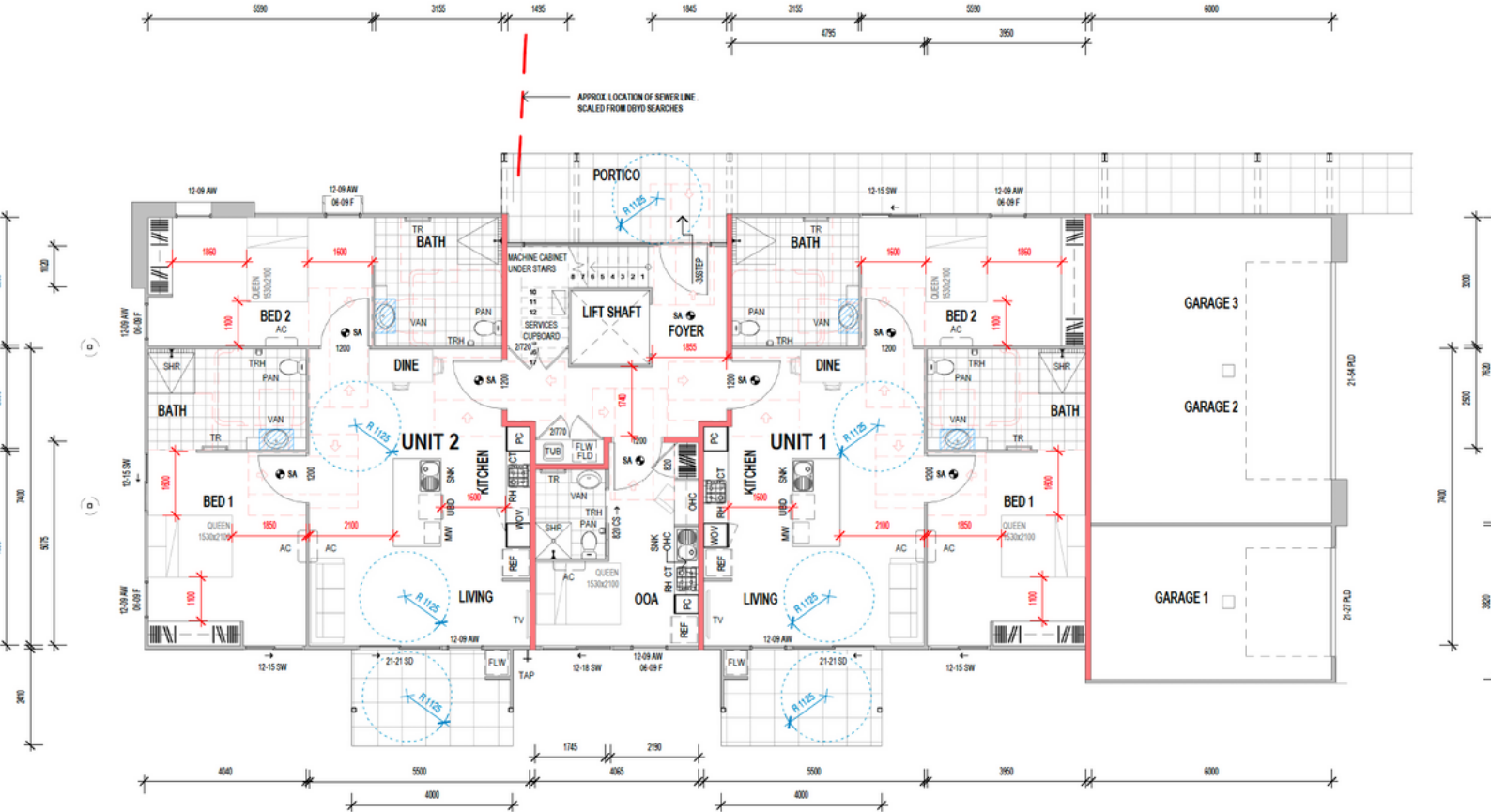

Ground Floor

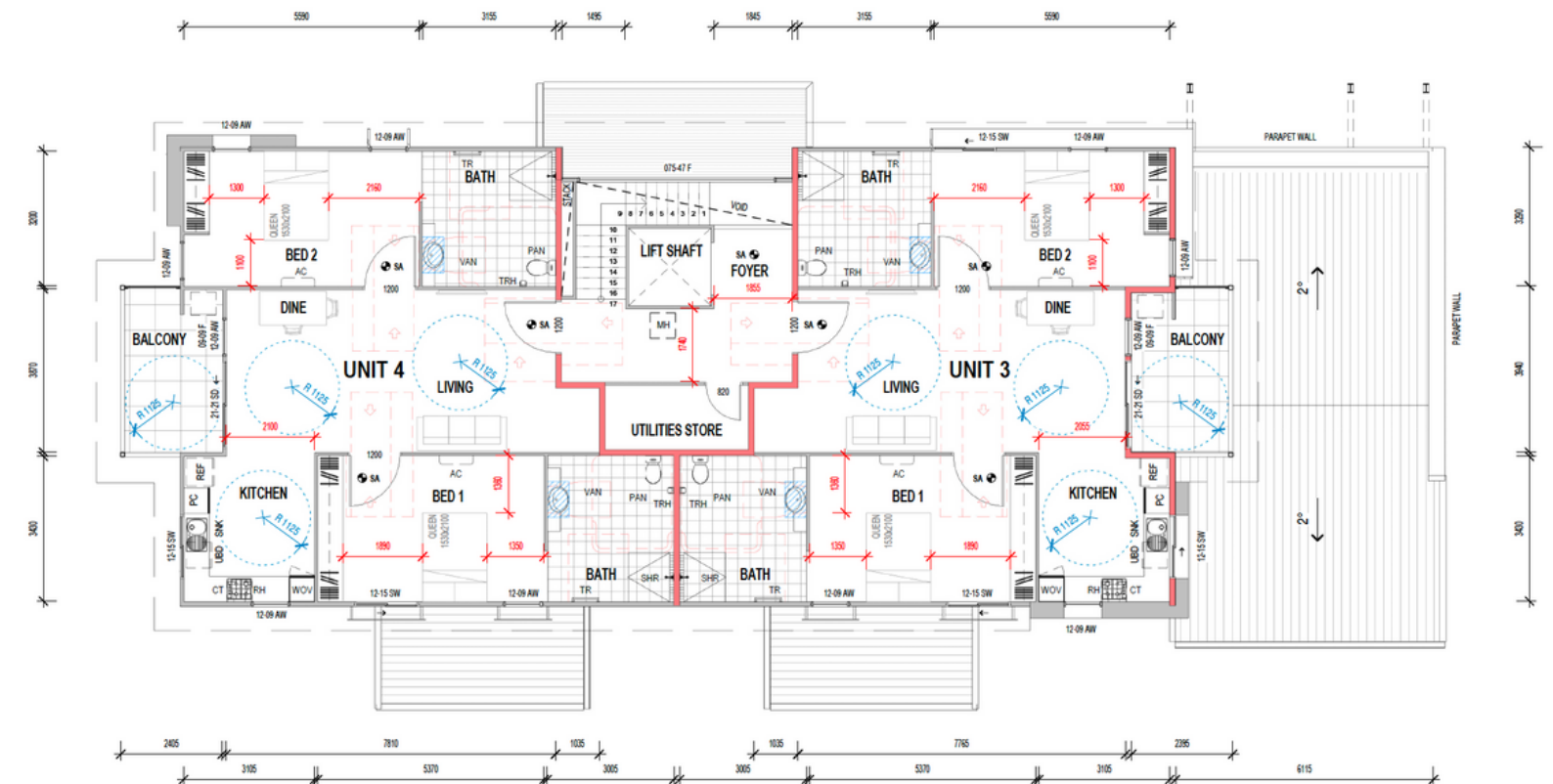

1st Floor

Income

SDA/building	\$429,890
Participant contribution	\$38,704
Total income	\$468,594
Gross yield	19.52%

Expenses

Property Management fee 11%	\$49,257
Gift to the participants \$100/wk/pt	\$20,800
Yard maintenance	\$1,200
Rates	\$3,000
Insurance	\$3,000
Total expenses	\$77,257

Net income	\$391,336
Poss Net yield	16.31%

Note: Incomes & projected yields are subject to occupancy & type of participants housed



**Disability Homes
Investments**

Strong Yields with the Power to Change Lives

Tel: 0492 863075